

ACS distribution board system for construction sites

68 ACS Range





68 ACS Range

ACS distribution board system for construction sites

ACS distribution board system for construction sites

System of boards, wired and certified in accordance to EN 61439-4, with different socket-outlets and circuit breakers combinations, for energy distribution on small and large construction sites.

- High impact and UV rays resistance.
- Additional panels to increase the functions, with supplementary interlocked switched socket-outlets (up to 12 per board) and modular protection circuit breakers (up to 160A).
- Circuit protection via modular and moulded-case switches up to 60 DIN EN 50022 modules.
- Empty and wired versions, customized and certified via Customer Service and GWENERGY software.



Solutions for small and large construction sites

The range includes wired boards for various applications, from the small construction sites to the largest one: 46QP polyester boards, 68 Q-DIN and 68 Q-BOX distribution boards. The range is completed with a selection of multi-functional floodlights for mobile use, and luminous indicator devices such as rectangular and oval luminaires and portable shockproof lamps.



Absolute safety

The 68 Q-BOX boards are designed with great attention to safety. All wired versions are fitted with an emergency push-button. In addition, the boards have a closing door and tear-proof cable-fastening hooks in stainless steel that block the power supply cable to the socket-outlets in the event of accidental tugging.

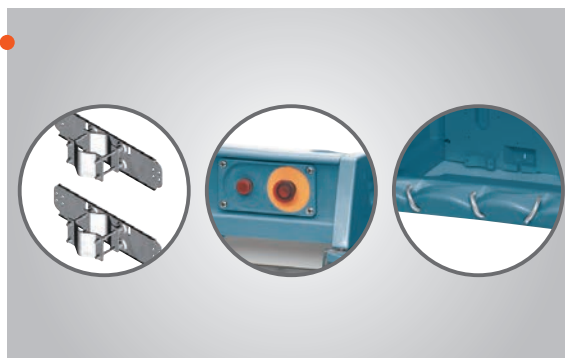

Personalised configurations

There are unwired versions ready for use, that can be personalised for all construction sites requirements. With GWENERGY software, you can certify the ACS boards quickly and easily.



Complying with Standard EN61439-4

The new EN61439-4 Standard replaces the previous EN60439-4, and lays down the guidelines and test procedures to be observed. In addition, this Standard implies the use of boards with specific UV resistance characteristics in accordance with EN62208.



EN 62208



Photograph the QR code to discover the new technical specifications



68 ACS Range

ACS distribution board system for construction sites

QP



SWITCHES

Code	CIRCUIT BREAKER	RESIDUAL CURRENT DEVICE
GW 68 521	MTHP 125A 4P C CHARACTERISTIC 16kA	ADD-ON RCD 125A 4P, A-TYPE, ADJUSTABLE
GW 68 526	MTX 160c 160A 4P TYPE B 16kA	ADD-ON RCD 160A 4P, "L"-SHEAPED, ADJUSTABLE
GW 68 531	MTX 250 250A 4P TYPE N 36kA	ADD-ON RCD 250A 4P, "L"-SHEAPED, ADJUSTABLE

Q-BOX 4



No. IEC 309/INTERLOCKED SOCKET-OUTLETS

DOMESTIC SOCKET

MAIN SWITCH

BOARD SUPPLY

Code	16A			32A			16A German standard	Miniature circuit breaker		Switch disconnector		BOARD SUPPLY
	2P+E	3P+E	3P+N+E	2P+E	3P+E	3P+N+E		No. poles	In (A)	No. poles	In (A)	
GW 68 481	3	1								4	40	Appliance plug
GW 68 482	2	2								4	40	
GW 68 483	2	2			1					4	63	
GW 68 484	2	1	1			1		4	63			
GW 68 511	3			1				2	63			Terminal block
GW 68 512	2	3								4	63	
GW 68 513	2	2			1					4	80	
GW 68 514	2	1	1			1				4	80	
GW 68 541	2	2				1	4					
GW 68 542	4	3				1						

Q-BOX 6



No. IEC 309/INTERLOCKED SOCKET-OUTLETS

DOMESTIC SOCKET

MAIN SWITCH

BOARD SUPPLY

Code	16A			32A		63A	16A German standard	Miniature circuit breaker		Switch disconnector		BOARD SUPPLY
	2P+E	3P+E	3P+N+E	3P+E	3P+N+E	3P+N+E		No. poles	In (A)	No. poles	In (A)	
GW 68 471	3	2		1						4	63	Appliance plug
GW 68 472	2	3		1						4	63	
GW 68 473	3	3								4	40	
GW 68 474	2		2		2					4	63	
GW 68 491	2		2		2			4	80			Terminal block
GW 68 492	2	1	1	1	1					4	80	
GW 68 493	3	2		1						4	80	
GW 68 494	2	2		2				4	80			
GW 68 495	2	1			3			4	100			
GW 68 496	3				2	1		4	100			
GW 68 497	2				2	2		4	100			
GW 68 543	3	2			1	1	4	4	100			
GW 68 544	6	3	1		2			4	80			

Q-DIN

							BOARD TYPE
	NO. IEC 309/INTERLOCKED SOCKET-OUTLETS			No. DOMESTIC SOCKET-OUTLETS	MAIN PROTECTION		
	16A		32A	16A	RCBO / RCD		
Code	2P+E	3P+E	3P+E	German std.	No. poles	In (A)	
GW 68 203 N	2			2	2P	16	Portable
GW 68 204 N	2	2			4P	16	
GW 68 216 N	4				2P	16	
GW 68 217 N	3				2P	16	
GW 68 223 N	3				2P	16	
GW 68 401 N	2	1		1	4P	16	With shockproof housing
							With metal support
GW 68 411 N	2	2		2	4P	25	With metal wheel support, revolving drum
GW 68 421 N	2	2	2	2	4P	40	
GW 68 424 N	2	1	1		4P	40	

Q-MC

										
	No. IEC 309 SOCKET-OUTLETS				MAIN PROTECTION		EMERGENCY BUTTON	Power supply's plug	IP DEGREE	BOARD TYPE
	16A			32A	Miniature circuit breaker					
Code	2P+E	3P+E	3P+N+E	3P+N+E	No. poles	In (A)				
GW 68 881 A	7				4	40A	Yes	3P+N+E 32A	56	Portable
GW 68 883 A	4	1	1	1	4	50A		3P+N+E 63A		
GW 68 884 A	2	1	2	1	4	50A		3P+N+E 63A		

COMBIBLOC

								
	No. IEC 309 SOCKET-OUTLETS			MAIN PROTECTION		Power supply's plug	IP DEGREE	BOARD TYPE
	16A		32A	No. poles	In (A)			
Code	2P+E	3P+N+E	3P+N+E					
GW 66 388	2	1		4	40	3P+N+E 32A	55	With metal support
GW 66 389	1	1	1	4	40	3P+N+E 32A		



68 ACS Range

ACS distribution board system for construction sites

68 QP ACS - WIRED BOARDS

46 QP - WATERTIGHT POLYESTER BOARDS - IP65

GW68526



WIRED POLYESTER BOARDS WITH BLANK DOOR EQUIPPED WITH LOCK - GREY RAL 7035

Code	Outer dim. LxHxD (mm)	In/out power supply	Mains switch	RCCB protection	Power suppliable (kW)	Pack Carton
No. of poles: 4						
GW 68 521	405x500x200	2xPG42	MTHP125	Side-by-side -adjustable	60	1
GW 68 526	405x500x200	2xPG42	MTX 160c	"L" shape lowered adjustable	75	1
GW 68 531	515x650x250	8xPG29	MTX 250	"L" shape adjustable	140	1

CHARACTERISTICS: polyester board, type 46F&E, blank door equipped with functional frame and one-way switch.

The last modular row of the board should be reserved for the cable input / output terminals. the cable glands for cable input / output are positioned on the back of the boards.

Board GW68531 envisages the use of 4 single input / output cords.

ACCESSORIES SUPPLIED: boards equipped with handles for transportation; set of 4 surface-mounting fixing brackets in stainless steel; key-operated security locks with handle mushroom-head emergency push-button connected to the minimum voltage release of the mains switch; PG-type cable glands for cable inlet and outlet.

68 Q-BOX - WIRED DISTRIBUTION BOARDS

Q-BOX 4 WITH TERMINAL BLOCK - IP55

GW68511



Q-BOX 4 FINAL DISTRIBUTION BOARDS WITH POWER SUPPLY TERMINAL BLOCK

Code	Socket-outlet 2P+E 16A - IB		Socket-outlet 2P+E 32A - IB		Pack Carton
	16A	32A	16A	32A	
GW 68 511	3		1		1

PROTECTIONS:

GW68511: Board In: 50A;

Main MCB 2P 63 A 230 V; Main Residual Current Device 2P 63A 0.03A class AC

3 MCB - MTC Range 2P 230 V 16 A C 6 kA for the three 2P+E 16 A 230 V interlocked socket-outlets

1 MCB - MTC Range 2P 230 V 32 A C 6 kA for the 2P+E 32 A 230 V interlocked socket-outlet

ACCESSORIES SUPPLIED: emergency push-button.

NOTE: products will be supplied with the new version, as shown in the picture, only after having sold out the previous one.

GW68513



Q-BOX 4 DISTRIBUTION BOARDS WITH SUPPLY TERMINAL BLOCK

Code	Socket-outlet 2P+E 16A - IEC 309		Socket-outlet 3P+E 16A - IB	Socket-outlet 3P+N+E 16A - IB	Socket-out 3P+E 32A - IB	Socket-outlet 3P+N+E 32A - IB	Pack Carton
	16A	32A	16A	16A	16A	32A	
GW 68 512	2		3				1
GW 68 513	2		2		1		1
GW 68 514	2		1	1		1	1

PROTECTIONS:

GW68512: Board In: 50A;

Main switch disconnecter 4P 63 A; Main Residual Current Device 4P 63A 0.03A class AC

1 MCB - MTC Range 2P 230 V 16 A C 6 kA for the two 2P+E 16 A 230 V non-interlocked socket-outlets

3 MCB - MTC Range 3P 400 V 16 A C 6 kA for the three 3P+E 16 A 400 V interlocked socket-outlets

GW68513: Board In: 64A;

Main switch disconnecter 4P 80 A Main Residual Current Device 4P 80A 0.03A class AC

1 MCB - MTC Range 2P 230 V 16 A C 6 kA for the two 2P+E 16 A 230 V non-interlocked socket-outlets

2 MCB - MTC Range 3P 400 V 16 A C 6 kA for the two 3P+E 16 A 400 V interlocked socket-outlets

1 MCB - MTC Range 3P 400 V 32 A C 6 kA for the 3P+E 32 A 400 V interlocked socket-outlet

GW68514: Board In: 64A;

Main switch disconnecter 4P 80 A; Main Residual Current Device 4P 80A 0.03A class AC

1 MCB - MTC Range 2P 230 V 16 A C 6 kA for the two 2P+E 16 A 230 V non-interlocked socket-outlets

1 MCB - MTC Range 3P 400 V 16 A C 6 kA for the 3P+E 16 A 400 V interlocked socket-outlet

1 MCB - MTC Range 4P 400 V 16 A C 6 kA for the 3P+N+E 16 A 400 V interlocked socket-outlet

1 MCB - MTC Range 4P 400 V 32 A C 6 kA for the 3P+N+E 32 A 400 V interlocked socket-outlet

ACCESSORIES SUPPLIED: emergency push-button.

NOTE: products will be supplied with the new version, as shown in the picture, only after having sold out the previous one.

GW68541



Q-BOX 4 FINAL DISTRIBUTION BOARDS WITH POWER SUPPLY TERMINAL BLOCK AND PANELS



Code	Socket-outlet 2P+E 16A - IB	Socket-outlet 3P+E 16A - IB	Socket-outlet 3P+N+E 32A - IB	German Std socket-outlet 16 A	Pack Carton
GW 68 541	2	2	1	4	1
GW 68 542	4	3	1		1

PROTECTIONS:

GW68541: Board In: 64A;

Main Residual Current Device 4P 80A 0.03A class AC

2 MCB - MTC Range 2P 230 V 16 A C 6 kA for the two 2P+E 16 A 230 V interlocked socket-outlets

2 MCB - MTC Range 2P 230 V 16 A C 6 kA for the four 2P+E 16 A 230 V domestic socket-outlets

1 MCB - MTC Range 3P 400 V 16 A C 6 kA for the two 3P+E 16 A 400 V interlocked socket-outlets

1 MCB - MTC Range 4P 400 V 32 A C 6 kA for the 3P+N+E 32 A 400 V interlocked socket-outlet

GW68542: Board In: 64A;

Main Residual Current Device 4P 80A 0.03A class AC

2 MCB - MTC Range 2P 230 V 16 A C 6 kA for the four 2P+E 16 A 230 V COMBIBLOC interlocked socket-outlets

2 MCB - MTC Range 3P 400 V 16 A C 6 kA for the three 3P+E 16 A 400 V COMBIBLOC interlocked socket-outlets

1 MCB - MTC Range 4P 400 V 32 A C 6 kA for the 3P+N+E 32 A 400 V COMBIBLOC interlocked socket-outlet

ACCESSORIES SUPPLIED: emergency push-button.

NOTE: products will be supplied with the new version, as shown in the picture, only after having sold out the previous one.



68 ACS Range

ACS distribution board system for construction sites

Q-BOX 4 WITH FIXED PLUG - IP55

GW68481



Q-BOX 4 FINAL DISTRIBUTION BOARDS WITH POWER SUPPLY PLUG 3P+N+E 32A



Code	Socket-outlet 2P+E 16A - IB	Socket-outlet 3P+E 16A - IB	Pack Carton
GW 68 481	3	1	1
GW 68 482	2	2	1

PROTECTIONS:

GW68481: Board In: 25A;

Main switch disconnecter 4P 40 A; Main Residual Current Device 4P 40A 0.03A class AC

1 MCB - MTC Range 2P 230 V 16 A C 6 kA for the three 2P+E 16 A 230 V interlocked socket-outlets

1 MCB - MTC Range 3P 400 V 16 A C 6 kA for the 3P+E 16 A 400 V interlocked socket-outlet

GW68482: Board In: 25A;

Main switch disconnecter 4P 40 A; Main Residual Current Device 4P 40A 0.03A class AC

1 MCB - MTC Range 2P 230 V 16 A C 6 kA for the two 2P+E 16 A 230 V interlocked socket-outlets

1 MCB - MTC Range 3P 400 V 16 A C 6 kA for the two 3P+E 16 A 400 V interlocked socket-outlets

ACCESSORIES SUPPLIED: socket-outlet/plug locking device, emergency push-button.

NOTE: products will be supplied with the new version, as shown in the picture, only after having sold out the previous one.

GW68483



Q-BOX 4 FINAL DISTRIBUTION BOARDS WITH POWER SUPPLY PLUG 3P+N+E 63A



Code	Socket-outlet 2P+E 16A - IEC 309	Socket-outlet 3P+E 16A - IB	Socket-outlet 3P+N+E 16A - IB	Socket-out 3P+E 32A - IB	Socket-outlet 3P+N+E 32A - IB	Pack Carton
GW 68 483	2	2		1		1
GW 68 484	2	1	1		1	1

PROTECTIONS:

GW68483: Board In: 50A;

Main switch disconnecter 4P 63A; Main Residual Current Device 4P 63A 0.03A class AC

1 MCB - MTC Range 2P 230 V 16 A C 6 kA for the two 2P+E 16 A 230 V non-interlocked socket-outlets

1 MCB - MTC Range 3P 400 V 16 A C 6 kA for the two 3P+E 16 A 400 V interlocked socket-outlets

1 MCB - MTC Range 3P 400 V 32 A C 6 kA for the 3P+E 32 A 400 V interlocked socket-outlet

GW68484: Board In: 50A;

Main MCB 4P 63 A 400 V; Main Residual Current Device 4P 63A 0.03A class AC

1 MCB - MTC Range 2P 230 V 16 A C 6 kA for the two 2P+E 16 A 230 V non-interlocked socket-outlets

1 MCB - MTC Range 3P 400 V 16 A C 6 kA for the 3P+E 16 A 400 V interlocked socket-outlet

1 MCB - MTC Range 4P 400 V 16 A C 6 kA for the 3P+N+E 16 A 400 V interlocked socket-outlet

1 MCB - MTC Range 4P 400 V 32 A C 6 kA for the 3P+N+E 32 A 400 V interlocked socket-outlet

ACCESSORIES SUPPLIED: socket-outlet/plug locking device, emergency push-button.

NOTE: products will be supplied with the new version, as shown in the picture, only after having sold out the previous one.

Q-BOX 6 WITH TERMINAL BLOCK - IP55

GW68491



Q-BOX 6 DISTRIBUTION BOARDS WITH SUPPLY TERMINAL BLOCK

	ACS EN 61439-1 EUROPEAN STANDARD		UV EN 62208		16A	16A	16A	32A	32A	
Code	Socket-outlet 2P+E 16A - IB	Socket-outlet 3P+E 16A - IB	Socket-outlet 3P+N+E 16A - IB	Socket-outlet 3P+N+E 32A - IB	Socket-outlet 3P+N+E 32A - IB	Socket-outlet 3P+N+E 32A - IB	Socket-outlet 3P+N+E 32A - IB	Socket-outlet 3P+N+E 32A - IB	Socket-outlet 3P+N+E 32A - IB	Pack Carton
GW 68 491	2		2							1
GW 68 494	2	2		2						1
GW 68 492	2	1	1	1			1			1
GW 68 493	3	2		1			1			1

PROTECTIONS:

GW68491: Board In: 64 A;

Main MCB 4P 80 A 400 V; Main Residual Current Device 4P 80A 0.03A class AC

1 MCB - MTC Range 2P 230 V 16 A C 6 kA for the two 2P+E 16 A 230 V interlocked socket-outlets

1 MCB - MTC Range 4P 400 V 16 A C 6 kA for the two 3P+N+E 16 A 400 V interlocked socket-outlets

2 MCB - MTC Range 4P 400 V 32 A C 6 kA for the two 3P+N+E 32 A 400 V interlocked socket-outlets

GW68494: Board In: 64 A;

Main MCB 4P 80 A 400 V; Main Residual Current Device 4P 80A 0.03A class AC

1 MCB - MTC Range 2P 230 V 16 A C 6 kA for the two 2P+E 16 A 230 V interlocked socket-outlets

1 MCB - MTC Range 3P 400 V 16 A C 6 kA for the two 3P+E 16 A 400 V interlocked socket-outlets

2 MCB - MTC Range 3P 400 V 32 A C 6 kA for the two 3P+E 32 A 400 V interlocked socket-outlets

GW68492: Board In: 64 A;

Main switch disconnector 4P 80 A; Main Residual Current Device 4P 80A 0.03A class AC.

1 MCB - MTC Range 2P 230 V 16 A C 6 kA for the two 2P+E 16 A 230 V interlocked socket-outlets

1 MCB - MTC Range 4P 400 V 16 A C 6 kA for the two interlocked socket-outlets

1 MCB - MTC Range 3P 400 V 32 A C 6 kA for the 3P+E 32 A 400 V interlocked socket-outlet

1 MCB - MTC Range 4P 400 V 32 A C 6 kA for the 3P+N+E 32 A 400 V interlocked socket-outlet

GW68493: Board In: 64 A;

Main switch disconnector 4P 80 A; Main Residual Current Device 4P 80A 0.03A class AC.

2 MCB - MTC Range 2P 230 V 16 A C 6 kA for the three 2P+E 16 A 230 V interlocked socket-outlets

1 MCB - MTC Range 3P 400 V 16 A C 6 kA for the two 3P+E 16 A 400 V interlocked socket-outlets

1 MCB - MTC Range 3P 400 V 32 A C 6 kA for the 3P+E 32 A 400 V interlocked socket-outlet

ACCESSORIES SUPPLIED: emergency push-button.

NOTE: products will be supplied with the new version, as shown in the picture, only after having sold out the previous one.

Q-BOX 6 FINAL BOARDS WITH POWER SUPPLY TERMINAL BLOCK

	ACS EN 61439-1 EUROPEAN STANDARD		UV EN 62208		16A	16A	32A	63A	16A	
Code	Socket-outlet 2P+E 16A - IB	Socket-outlet 3P+E 16A - IB	Socket-outlet 3P+N+E 16A - IB	Socket-outlet 3P+N+E 32A - IB	Socket-outlet 3P+N+E 32A - IB	Socket-outlet 3P+N+E 63A - IB	Socket-outlet 3P+N+E 63A - IB	German Std socket- outlet 16 A	Socket-outlet 3P+N+E 32A - IB	Pack Carton
GW 68 495	2	1		3						1
GW 68 496	3			2	1					1
GW 68 497	2			2	2					1
GW 68 543	3	2		1	1		4			1
GW 68 544	6	3	1	2						1

PROTECTIONS:

GW68495: Board In: 80 A;

Main MCB 4P 100 A 400 V; Main Residual Current Device 4P 100A 0.03A class A

1 MCB - MTC Range 2P 230 V 16 A C 6 kA for the two 2P+E 16 A 230 V interlocked socket-outlets;

1 MCB - MTC Range 3P 400 V 16 A C 6 kA for the 3P+E 16 A 400 V interlocked socket-outlet

3 MCB - MTC Range 4P 400 V 32 A C 6 kA for the three 3P+N+E 32 A 400 V interlocked socket-outlets

GW68496: Board In: 80 A;

Main MCB 4P 100 A 400 V;

Main Residual Current Device 4P 100A 0.03A class A

2 MCB - MTC Range 2P 230 V 16 A C 6 kA for the three 2P+E 16 A 230 V interlocked socket-outlets;

2 MCB - MTC Range 4P 400 V 32 A C 6 kA for the two 3P+N+E 32 A 400 V interlocked socket-outlets

1 MCB - MT Range 4P 400 V 63 A C 6 kA for the 3P+N+E 63 A 400 V interlocked socket-outlet

GW68497: Board In: 80 A;

Main MCB 4P 100 A 400 V; Main Residual Current Device 4P 100A 0.03A class A

1 MCB - MTC Range 2P 230 V 16 A C 6 kA for the two 2P+E 16 A 230 V interlocked socket-outlets;

2 MCB - MTC Range 4P 400 V 32 A C 6 kA for the two 3P+N+E 32 A 400 V interlocked socket-outlets

1 MCB - MT Range 4P 400 V 63 A C 6 kA for the 3P+N+E 63 A 400 V two interlocked socket-outlets

GW68543: Board In: 80 A;

Main MCB 4P 100 A 400 V;

Main Residual Current Device 4P 100A 0.03A class AC

2 MCB - MTC Range 2P 230 V 16 A C 6 kA for the three 2P+E 16 A 230 V interlocked socket-outlets;

2 MCB - MTC Range 2P 230 V 16 A C 6 kA for the four 2P+E 16 A 230 V domestic socket-outlets

1 MCB - MTC Range 3P 400 V 16 A C 6 kA for the two 3P+E 16 A 400 V interlocked socket-outlets;

1 MCB - MTC Range 4P 400 V 32 A C 6 kA for the 3P+N+E 32 A 400 V interlocked socket-outlet

1 MCB - MT Range 4P 400 V 63 A C 6 kA for the 3P+N+E 63 A 400 V interlocked socket-outlet

GW68544: Board In: 64 A;

Main MCB 4P 80 A 400 V

Main Residual Current Device 4P 100A 0.03A class AC

4 MCB - MTC Range 2P 230 V 16 A C 6 kA for the six 2P+E 16 A 230 V COMBIBLOC interlocked socket-outlets;

2 MCB - MTC Range 3P 400 V 16 A C 6 kA for the three 3P+E 16 A 400 V COMBIBLOC interlocked socket-outlets

1 MCB - MTC Range 4P 400 V 16 A C 6 kA for the 3P+N+E 16 A 400 V COMBIBLOC interlocked socket-outlet;

1 MCB - MTC Range 4P 400 V 32 A C 6 kA for the two 3P+N+E 32 A 400 V COMBIBLOC interlocked socket-outlets

ACCESSORIES SUPPLIED: emergency push-button.

CHARACTERISTICS: in the boards GW68543 and GW68544, the socket-outlets are installed on accessory panels.

NOTE: products will be supplied with the new version, as shown in the picture, only after having sold out the previous one.

GW68496





68 ACS Range

ACS distribution board system for construction sites

Q-BOX 6 WITH FIXED PLUG - IP55

GW68473



Q-BOX 6 FINAL DISTRIBUTION BOARDS WITH POWER SUPPLY PLUG 3P+N+E 32A



Code	Socket-outlet 2P+E 16A - IB	Socket-outlet 3P+E 16A - IB	Pack Carton
GW 68 473	3	3	1

Board In: 25 A

PROTECTIONS: Main switch disconnecter 4P 40 A; Main Residual Current Device 4P 40A 0.03A class AC

1 MCB - MTC Range 2P 230 V 16 A C 6 kA for the three 2P+E 16 A 230 V interlocked socket-outlets

1 MCB - MTC Range 3P 400 V 16 A C 6 kA for the three 3P+E 16 A 400 V interlocked socket-outlets

ACCESSORIES SUPPLIED: socket-outlet/plug locking device, emergency push-button.

NOTE: products will be supplied with the new version, as shown in the picture, only after having sold out the previous one.

GW68471



Q-BOX 6 DISTRIBUTION BOARDS WITH POWER SUPPLY PLUG 3P+N+E 63A



Code	Socket-outlet 2P+E 16A - IB	Socket-outlet 3P+E 16A - IB	Socket-outlet 3P+N+E 16A - IB	Socket-out 3P+E 32A - IB	Socket-outlet 3P+N+E 32A - IB	Pack Carton
GW 68 471	3	2		1		1
GW 68 472	2	3		1		1
GW 68 474	2		2		2	1

PROTECTIONS:

GW68471: Board In: 50A;

Main switch disconnecter 4P 63A; Main Residual Current Device 4P 63A 0.03A class AC

1 MCB - MTC Range 2P 230 V 16 A C 6 kA for the three 2P+E 16 A 230 V interlocked socket-outlets

1 MCB - MTC Range 3P 400 V 16 A C 6 kA for the two 3P+E 16 A 400 V interlocked socket-outlets

1 MCB - MTC Range 3P 400 V 32 A C 6 kA for the 3P+E 32 A 400 V interlocked socket-outlet

GW68472: Board In: 50A;

Main switch disconnecter 4P 63A; Main Residual Current Device 4P 63A 0.03A class AC

1 MCB - MTC Range 2P 230 V 16 A C 6 kA for the two 2P+E 16 A 230 V interlocked socket-outlets

1 MCB - MTC Range 3P 400 V 16 A C 6 kA for the three 3P+E 16 A 400 V interlocked socket-outlets

1 MCB - MTC Range 3P 400 V 32 A C 6 kA for the 3P+E 32 A 400 V interlocked socket-outlet

GW68474: Board In: 50A;

Main switch disconnecter 4P 63A; Main Residual Current Device 4P 63A 0.03A class AC.

1 MCB - MTC Range 2P 230 V 16 A C 6 kA for the two 2P+E 16 A 230 V interlocked socket-outlets

1 MCB - MTC Range 4P 400 V 16 A C 6 kA for the two 3P+N+E 16 A 400 V interlocked socket-outlets

1 MCB - MTC Range 4P 400 V 32 A C 6 kA for the two 3P+N+E 32 A 400 V interlocked socket-outlets

ACCESSORIES SUPPLIED: socket-outlet/plug locking device, emergency push-button.

NOTE: products will be supplied with the new version, as shown in the picture, only after having sold out the previous one.

COMPLEMENTARY ITEMS

GW68463



METAL SUPPORT PAINTED IN YELLOW FOR Q-BOX 4/6

Code	Outer dim. LxHxD (mm)	Pack Carton
GW 68 463	1100x1650x630	1

CHARACTERISTICS: 2 side handles for manual handling; 2 slots on the top for lifting with a crane.

GW46554



POLE SUPPORT KIT

Code	For distribution boards	Pack Carton
GW 46 553	GW68521, GW68526	1
GW 46 554	GW68531, Q-BOX 4	1

APPLICATIONS: for applications of the boards on poles from 60 to 80mm and, by means of a banding (not included with the accessories supplied), from 80 to 200mm.

CHARACTERISTICS: fixed on the back of the boards.

68 Q-DIN - WIRED BOARDS

Q-DIN 5 - MOBILE, PORTABLE BOARDS

GW68217N



Q-DIN 5 ACS BOARD WITH CABLE AND PLUG IEC 309 - IP65



Code	Socket-outlet 2P+E 16A - IEC 309	Pack Carton
GW 68 217 N	3	1/3

Board In: 14A

PROTECTIONS: 1 RCBO - MDC Range 2P 230 V 16 A C 6 kA 0,03 A - AC Type

ACCESSORIES SUPPLIED: 5 m of cable H 07 RN - F for connection to the mains and plug IEC 309 2P+E 16A 230V IP 67.

NOTE: products will be supplied with the new version, as shown in the picture, only after having sold out the previous one.

GW68223N



Q-DIN 5 ACS BOARD IN YELLOW SHOCKPROOF CASE WITH CABLE AND PLUG IEC 309 - IP65



Code	Socket-outlet 2P+E 16A - IEC 309	Pack Carton
GW 68 223 N	3	1/2

Board In: 14A

PROTECTIONS: 1 RCBO - MDC Range 2P 230 V 16 A C 6 kA 0,03 A - AC Type

ACCESSORIES SUPPLIED: 5 m of cable H 07 RN - F for connection to the mains and plug IEC 309 2P+E 16A 230V IP 67.

NOTE: products will be supplied with the new version, as shown in the picture, only after having sold out the previous one.

Q-DIN 10 - MOBILE, PORTABLE BOARDS

GW68203N



Q-DIN 10 ACS BOARD WITH CABLE AND PLUG IEC 309 - IP44



Code	Socket-outlet 2P+E 16A - IEC 309	German Std socket-outlet 16 A	Pack Carton
GW 68 203 N	2	2	1/3

Board In: 14A

PROTECTIONS: 1 RCBO - MDC Range 2P 230 V 16 A C 6 kA 0,03 A - AC Type

ACCESSORIES SUPPLIED: 5 m of cable H 07 RN - F for connection to the mains and plug IEC 309 2P+E 16A 230V IP 44.

CHARACTERISTICS: Italian German standard socket-outlets with side earth and plug pins Ø 4.8 mm.

NOTE: products will be supplied with the new version, as shown in the picture, only after having sold out the previous one.

GW68204N



Q-DIN 10 ACS BOARD WITH CABLE AND PLUG IEC 309 - IP65



Code	Socket-outlet 2P+E 16A - IEC 309	Socket-outlet 3P+E 16A - IEC 309	Pack Carton
GW 68 204 N	2	2	1/2

Board In: 14A

PROTECTIONS: 1 RCBO - MDC Range 4P 400 V 16 A C 6 kA 0,03 A - AC Type

ACCESSORIES SUPPLIED: 5 m of cable H 07 RN - F for connection to the mains and plug IEC 309 3P+N+E 16A 400V IP 67.

NOTE: products will be supplied with the new version, as shown in the picture, only after having sold out the previous one.

GW68216N



Q-DIN 10 BOARD EQUIPPED WITH CABLE AND PLUG IEC 309 - IP65



Code	Socket-outlet 2P+E 16A - IEC 309	Pack Carton
GW 68 216 N	4	1/2

Board In: 14A

PROTECTIONS: 1 RCBO - MDC Range 2P 230 V 16 A C 6 kA 0,03 A - AC Type

ACCESSORIES SUPPLIED: 5 m of cable H 07 RN - F for connection to the mains and plug IEC 309 2P+E 16A 230V IP 67.

NOTE: products will be supplied with the new version, as shown in the picture, only after having sold out the previous one.



68 ACS Range

ACS distribution board system for construction sites

GW68401N



Q-DIN 10 ACS BOARD WITH CABLE AND PLUG IEC 309 WITH YELLOW PAINTED ACCIDENT PREVENTION METAL CONDUIT SUPPORT AND CABLE SUPPORT - IP44



Code	Socket-outlet 2P+E 16A - IEC 309	Socket-outlet 3P+E 16A - IEC 309	German Std socket-outlet 16 A	Pack Carton
GW 68 401 N	2	1	1	1

Board In: 14A

PROTECTIONS: 1 RCBO - MDC Range 4P 400 V 16 A C 6 kA 0.03 A - ACType

ACCESSORIES SUPPLIED: 15 m of cable H 07 RN - F for connection to the mains and plug IEC 309 3P+N+E 16A 400V IP 44.

CHARACTERISTICS: Italian German standard socket-outlets with side earth and plug pins Ø 4.8 mm.

NOTE: products will be supplied with the new version, as shown in the picture, only after having sold out the previous one.

Q-DIN 14 - PORTABLE BOARDS

GW68411N



Q-DIN 14 ACS BOARD WITH CABLE AND PLUG IEC 309 WITH YELLOW- PAINTED ACCIDENT PREVENTION METAL CONDUIT CARRIAGE WITH TWO WHEELS AND ROTARY DRUM FOR REWINDING AND STORING THE CABLE - IP44



Code	Socket-outlet 2P+E 16A - IEC 309	Socket-outlet 3P+E 16A - IEC 309	German Std socket-outlet 16 A	Pack Carton
GW 68 411 N	2	2	2	1

Board In: 16A

PROTECTIONS: Main Residual Current Device 4P 25A 0.03A class AC

1 MCB - MTC Range 2P 230 V 16 A C 6 kA for the two 2P+E 16 A 230 V non-interlocked socket-outlets

1 MCB - MTC Range 2P 230 V 16 A C 6 kA for the two 2P+E 10/16 A 230 V domestic socket-outlets

1 MCB - MTC Range 3P 400 V 16 A C 6 kA for the two 3P+E 16 A 400 V non-interlocked socket-outlets

ACCESSORIES SUPPLIED: 25 m of cable H 07 RN - F for connection to the mains and plug IEC 309 3P+N+E 16A 400V IP 44

CHARACTERISTICS: Italian German standard socket-outlets with side earth and plug pins Ø 4.8 mm. MTC compact miniature circuit breakers are C curve 6kA.

NOTE: products will be supplied with the new version, as shown in the picture, only after having sold out the previous one.

Q-DIN 20 - PORTABLE BOARDS

GW68421N



Q-DIN 20 ACS BOARD WITH CABLE AND PLUG IEC 309 WITH YELLOW-PAINTED METAL CONDUIT CARRIAGE WITH TWO WHEELS AND ROTARY DRUM FOR REWINDING AND STORING THE CABLE - IP44



Code	Socket-outlet 2P+E 16A - IEC 309	Socket-outlet 3P+E 16A - IEC 309	Socket-outlet 3P+E 32A - IEC 309	German Std socket-outlet 16 A	Pack Carton
GW 68 421 N	2	2	2	2	1

Boards In: 32A

PROTECTIONS: Main Residual Current Device 4P 40A 0.03A class AC

1 MCB - MTC Range 2P 230 V 16 A C 6 kA for the two 2P+E 16 A 230 V non-interlocked socket-outlets

1 MCB - MTC Range 2P 230 V 16 A C 6 kA for the two 2P+E 10/16 A 230 V domestic socket-outlets

1 MCB - MTC Range 3P 400 V 16 A C 6 kA for the two 3P+E 16 A 400 V non-interlocked socket-outlets

1 MCB - MTC Range 3P 400 V 32 A C 6 kA for the two 3P+E 32 A 400 V non-interlocked socket-outlets

ACCESSORIES SUPPLIED: 35 m of cable H 07 RN - F for connection to the mains and plug IEC 309 3P+N+E 32A 400V IP 44.

CHARACTERISTICS: Italian German standard socket-outlets with side earth and plug pins Ø 4.8 mm.

NOTE: products will be supplied with the new version, as shown in the picture, only after having sold out the previous one.

GW68424N



Q-DIN 20 ACS BOARD WITH CABLE AND PLUG IEC 309 WITH YELLOW-PAINTED METAL CONDUIT CARRIAGE WITH TWO WHEELS AND ROTARY DRUM FOR REWINDING AND STORING THE CABLE - IP65



Code	Socket-outlet 2P+E 16A - IB	Socket-outlet 3P+E 16A - IB	Socket-out 3P+E 32A - IB	Pack Carton
GW 68 424 N	2	1	1	1

Boards In: 32A

PROTECTIONS: Main Residual Current Device 4P 40A 0.03A class AC

1 MCB - MTC Range 2P 230 V 16 A C 6 kA for the two 2P+E 16 A 230 V interlocked socket-outlets

1 MCB - MTC Range 3P 400 V 16 A C 6 kA for the 3P+E 16 A 400 V interlocked socket-outlet

1 MCB - MTC Range 3P 400 V 32 A C 6 kA for the 3P+E 32 A 400 V interlocked socket-outlet

ACCESSORIES SUPPLIED: 25 m of cable H 07 RN - F for connection to the mains and plug IEC 309 3P+N+E 32A 400V IP 67.

NOTE: products will be supplied with the new version, as shown in the picture, only after having sold out the previous one.

66 COMBIBLOC - WIRED BOARDS

COMBIBLOC - PORTABLE DISTRIBUTION BOARDS

GW66388



COMBIBLOC ASC BOARDS EQUIPPED WITH CABLE AND PLUG IEC309 METAL CONDUIT SUPPORT YELLOW-PAINTED SUPPORT - IP55



Code	Socket-outlet 2P+E 16A - IB	Socket-outlet 3P+N+E 16A - IB	Socket-outlet 3P+N+E 32A - IB	Pack Carton
GW 66 388	2	1		1
GW 66 389	1	1	1	1

PROTECTIONS:

GW66388: Board In: 32 A;

Main RCD 4P 40 A 0.03 A AC Type

2 MCB - MTC Range 2P 230 V 16 A C 6 kA for the two 2P+E 16 A 230 V interlocked socket-outlets

1 MCB - MTC Range 4P 400 V 16 A C 6 kA for the 3P+N+E 16 A 400 V interlocked socket-outlet

GW66389: Board In: 32A;

Main RCD 4P 40 A 0.03 A AC Type

1 MCB - MTC Range 2P 230 V 16 A C 6 kA for the 2P+E 16 A 230 V interlocked socket-outlet

1 MCB - MTC Range 4P 400 V 16 A C 6 kA for the 3P+N+E 16 A 400 V interlocked socket-outlet

1 MCB - MTC Range 4P 400 V 32 A C 6 kA for the 3P+N+E 32 A 400 V interlocked socket-outlet

ACCESSORIES SUPPLIED: IEC 309 power supply plug for GW66388 and GW66389 3P+N+E 32 A; 5 mt of H 07 RN - F cable for supply



68 ACS Range

ACS distribution board system for construction sites

68 Q-MC - WIRED TERMINALS

Q-MC 16T - MOBILE TERMINALS

GW68881A



QMC 16T ACS TRANSPORTABLE WIRED TERMINAL

WITH DOUBLE-FACE TAKE-OFF

EQUIPPED WITH NON-INTERLOCKED SWITCHED SOCKET-OUTLETS - IP56



Code	Socket-outlet 2P+E 16A - IEC 309	Socket-outlet 3P+E 16A - IEC 309	Socket-outlet 3P+N+E 16A - IEC 309	Socket-outlet 3P+N+E 32A - IEC 309	Pack Carton
GW 68 881 A	7				1
GW 68 883 A	4	1	1	1	1
GW 68 884 A	2	1	2		1

PROTECTIONS:

GW68881A: Board In: 25 A;

Main RCD 4P 40 A 0.03 A AC Type

6 MCB - MTC Range 2P 230 V 16 A C 6 kA

GW68883A: Board In: 40A;

Main MCB 4P 50A 10kA C characteristic;

Main RCD 4P 63A 0.03A class AC

2 MCB - MTC Range 2P 230 V 16 A C 6 kA for the four 2P+E 16 A 230 V non-interlocked socket-outlets

1 MCB - MTC Range 4P 400 V 16 A C 6 kA for the 3P+N+E 16 A 400 V and 3P+E 16 A 400 V non-interlocked socket-outlets

1 MCB - MTC Range 4P 400 V 32 A C 6 kA for the 3P+N+E 32 A 400 V non-interlocked socket-outlet

GW68884A: Board In: 40 A;

Main MCB 4P 50 A 10 kA C characteristic;

Main RCD 4P 63 A 0.03 A AC Type

1 MCB - MTC Range 2P 230 V 16 A C 6 kA for the two 2P+E 16 A 230 V non-interlocked socket-outlets

1 MCB - MTC Range 3P 400 V 16 A C 6 kA for the 3P+E 16 A 400 V non-interlocked socket-outlet

1 MCB - MTC Range 4P 400 V 16 A C 6 kA for the two 3P+N+E 16 A 400 V non-interlocked socket-outlets

1 MCB - MTC Range 4P 400 V 32 A C 6 kA for the 3P+N+E 32 A 400 V non-interlocked socket-outlet

ACCESSORIES SUPPLIED: IEC 309 power supply plug for GW68881 3P+N+E 32 A; for GW68883, GW68884 3P+N+E 63 A 5m cable, 5x10mm²

H07RN-F of network connection for GW68883, GW68884 5m cable, 5x4mm². H07RN-F of network connection for GW68881 emergency push-button; emergency push-button.

CHARACTERISTICS: stainless steel cable fastener devices; enclosure with hinged opening that can be fitted with security lock, for access to modular devices.

NOTE: products will be supplied with the new version, as shown in the picture, only after having sold out the previous one.

ACS PREDETERMINED CONSTRUCTION SYSTEM COMPONENTS

46 QP - WATERTIGHT POLYESTER BOARDS - IP65

GW46004



WATERTIGHT POLYESTER BOARDS WITH BLANK DOOR EQUIPPED WITH LOCK - GREY RAL 7035



Code	Outer dim. LxHxD (mm)	No. of modules EN 50022	No. locks	Dispersible power A (W)	Dispersible power B (W)	Pack Carton
GW 46 003	405x500x200	54 (18x3)	2	105	53	1
GW 46 004	405x650x200	72 (18x4)	2	118	81	1
GW 46 005	515x650x250	96 (24x4)	2	126	106	1
GW 46 006	585x800x300	140 (28x5)	2	205	146	1

CHARACTERISTICS: boxes equipped with inserts pre-assembled in the slots, to speed up the configuration of the board. Doors equipped with functional grid of reference for fixing the devices. Panels with windows or blank panels (height 1 or 2 modules) can be fixed directly in the seats created on the side walls of the board.

Impact resistance: IK10, in compliance with EN 62262. GWT: 960°C.

ACCESSORIES SUPPLIED: screwcaps for double insulation, 4 reversible squares with the relative bolts and screws for fixing the back-mounting plates or uprights for modular devices.

NOTES: dispersible power calculated according to CEI 23-49.

Dispersible power A (W): board configuration with back-mounting plate (as far back as possible).

Dispersible power B (W): board configuration with DIN rails + panels with windows.

The technical and operating characteristics, and the nominal values, refer to vertical installation only.

It is necessary use GWEnergy software to realize certification in accordance with ACS standard and the GEWISS construction system.

GW46206



WATERTIGHT POLYESTER BOARDS WITH DOOR EQUIPPED WITH TRANSPARENT WINDOW AND LOCK GREY RAL 7035



Code	Outer dim. LxHxD (mm)	No. of modules EN 50022	No. locks	Dispersible power A (W)	Dispersible power B (W)	Pack Carton
GW 46 203	405x500x200	54 (18x3)	2	105	53	1
GW 46 204	405x650x200	72 (18x4)	2	118	81	1
GW 46 205	515x650x250	96 (24x4)	2	126	106	1
GW 46 206	585x800x300	140 (28x5)	2	205	146	1

CHARACTERISTICS: boxes equipped with inserts pre-assembled in the slots, to speed up the configuration of the board. For the transparent window version: GWT 650°C.

Windowed or blank panels (height 1 or 2 modules) can be fixed directly in the seats created on the side walls of the board.

Impact resistance: IK10, in compliance with EN 62262. GWT: 960°C.

ACCESSORIES SUPPLIED: screwcaps for double insulation, 4 reversible squares with the relative bolts and screws for fixing the back-mounting plates or uprights for modular devices.

NOTES: dispersible power calculated according to CEI 23-49.

Dispersible power A (W): board configuration with back-mounting plate (as far back as possible).

Dispersible power B (W): board configuration with DIN rails + panels with windows.

The technical and operating characteristics, and the nominal values, refer to vertical installation only.

It is necessary use GWEnergy software to realize certification in accordance with ACS standard and the GEWISS construction system.

COMPLEMENTARY ITEMS FOR BOARDS 46 QP - FRONT CONFIGURATION

GW46421F



COVERING PANELS WITH WINDOW, HEIGHT 1 MODULE FAST & EASY ASSEMBLY - GREY RAL 7035

Code	No. of modules EN 50022	For standard boards (mm)	Characteristics	Pack Carton
GW 46 421 F	18	405	Halogen free	1/10
GW 46 422 F	24	515	Halogen free	1/10
GW 46 423 F	28	585	Halogen free	1/5

CHARACTERISTICS: captive panel 1/4 turn sealing screws.

GW46421F, GW46422F, GW46423F, possibility to fix directly on the inner walls of the polyester boards.

ACCESSORIES SUPPLIED: fixing accessories. Complete with DIN rail.

GW46426F



FAST & EASY QUICK ASSEMBLY BLANK COVERING PANELS - GREY RAL 7035

Code	For standard boards (mm)	Characteristics	Pack Carton
Height: 1 Module			
GW 46 426 F	405	Halogen free	1/10
GW 46 427 F	515	Halogen free	1/13
GW 46 428 F	585	Halogen free	1/5

CHARACTERISTICS: captive panel 1/4 turn sealing screws.

GW46426F, GW46427F, GW46428F, possibility to fix directly on the inner walls of the polyester boards.

ACCESSORIES SUPPLIED: fixing accessories.



68 ACS Range

ACS distribution board system for construction sites



GW46476F

BLANK COVERING PANELS - FAST & EASY QUICK ASSEMBLY - GREY RAL 7035

Code	For standard boards (mm)	Characteristics	Pack Carton
Height: 2 Modules			
GW 46 476 F	405	Halogen free	1/5
GW 46 477 F	515	Halogen free	1/5
GW 46 478 F	585	Halogen free	1/5

CHARACTERISTICS: captive panel 1/4 turn sealing screws.

GW46476, GW46477, GW46478F possibility to fix directly on the inner walls of the polyester boards.

ACCESSORIES SUPPLIED: fixing accessories.



GW46437F

PAIRS OF UPRIGHTS FOR INSTALLATION OF FAST & EASY QUICK ASSEMBLY TECHNICAL COMPONENTS FOR MODULAR EQUIPMENT, MOULDED-CASE DEVICES AND DISCONNECTING SWITCHES

Code	For boards LxH (mm)	Pack Carton
GW 46 436 F	405x500	1/10
GW 46 437 F	405x650/515x650	1/10
GW 46 438 F	585x800	1/10

APPLICATIONS: allow you to create extractable frames by using covering panels and/or DIN rails and perforated or full plates with a height of 1 or 2 modules and moulded-case device kits and knife switches.



GW46433F

FAST & EASY QUICK ASSEMBLY DIN RAILS

Code	No. of modules EN 50022	For standard boards (mm)	Pack Carton
GW 46 431 F	18	405	1/10
GW 46 432 F	24	515	1/10
GW 46 433 F	28	585	1/10

ACCESSORIES SUPPLIED: accessories for fixing to panel brackets.

NOTES: To use the DIN rails without the relative blank panel, use the GW46524F kit.

To restore the minimum degree of protection of the open door board, use the relative inner door.



GW46531F

FAST & EASY QUICK ASSEMBLY DOUBLE DIN RAILS

Code	No. of modules EN 50022	For standard boards (mm)	Pack Carton
GW 46 531 F	18	405	1/10
GW 46 532 F	24	515	1/10
GW 46 533 F	28	585	1/10

APPLICATIONS: suitable for use with the GWFIX 100 system.

ACCESSORIES SUPPLIED: accessories for fixing to panel brackets.

NOTES: the use of the dual DIN rails prevents the positioning of the vertical trunking.

To use the DIN rails without the relative blank panel, use the GW46524F kit.

To restore the minimum degree of protection of the open door board, use the relative inner door.



GW46570F

KIT OF MOULDED-CASE DEVICES AND SWITCH-DISCONNECTORS - FIXING BY MEANS OF UPRIGHTS PANELS, HEIGHT 2 MODULES - GREY RAL 7035

Code	MCCB Type	RCD Position	For standard boards (mm)	Pack Carton
Equipment fixing: Plate, DIN rail EN 50022				
GW 46 570 F	MTX 160c - MTX 160 - MTX 250	"L"-shaped	405	1
GW 46 571 F	MTX 160c - MTX 160 - MTX 250	"L"-shaped	515	1
GW 46 572 F	MTX 160c - MTX 160 - MTX 250	"L"-shaped	585	1

CHARACTERISTICS: panels with windowing H=45mm; captive and sealing 1/4 turn screws. Fixed with uprights.

Pre-arrangement for vertically positioned devices. Halogen-free plastic material.

ACCESSORIES SUPPLIED: fixing accessories.

NOTES: the MTX 160c and MTX 160 (both 3P and 4P) must be fixed to the DIN rail using the special brackets contained in the GWD8261 kit.

The MTX 250 (both 3P and 4P) require the GWD8262 kit.

The coupling of the MTX moulded-case devices - and relative residual current device - on the DIN rail requires the use of special brackets that can be found in the appropriate section of the DIN catalogue.

You are advised to always insert a blank panel above the moulded-case/switch-disconnector kit, to facilitate the cord positioning in the case of cord entry from the bottom.

The MSS switch-disconnectors cannot be installed together with MTX moulded-case devices on a single DIN rail from the kit, as they are of differing depths

The peak current of the one-way switch indicated (in line with the presumed short-circuit current in the installation point) must NOT be greater than 17kA.

The presumed short-circuit current in the power supply line of the main switch of the board must NOT be greater than 10kA.

INTERNAL CONFIGURATION

GW46403



STEEL BACK-MOUNTING PLATES WITH ANTI-CORROSION TREATMENT FOR THE ASSEMBLY OF NON-MODULAR EQUIPMENT

Code	For boards LxH (mm)	Pack Carton
GW 46 403	405x500	1/5
GW 46 404	405x650	1/5
GW 46 405	515x650	1/4
GW 46 406	585x800	1/3

NOTES: for further information relating to the maximum applicable loads, see the table on the corresponding pages of the technical catalogue.

GW46410



BACK-MOUNTING PLATES IN INSULATING MATERIAL FOR THE ASSEMBLY OF NON-MODULAR EQUIPMENT

Code	For boards LxH (mm)	Pack Carton
GW 46 410	405x500	1/5
GW 46 411	405x650	1/4
GW 46 412	515x650	1/3
GW 46 413	585x800	1/2

NOTES: for further information relating to the maximum applicable loads, see the table on the corresponding pages of the technical catalogue.

SERVICE COMPLEMENTARY ITEMS FOR BOARDS 46 QP

GW46451



SET OF 4 STEEL BRACKETS FOR FIXING SURFACE-MOUNTING BOARDS

Code	Material	Accessories supplied	Pack Carton
GW 46 446	Galvanised steel	Self-tapping fixing screws	20
GW 46 451	Stainless steel	Self-tapping fixing screws	20

GW46554

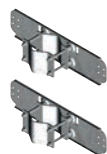

POLE SUPPORT KIT

Code	For boards LxH (mm)	Max sustainable load (kg)	Pack Carton
GW 46 553	405x500/405x650	125	1
GW 46 554	515x650	125	1
GW 46 555	585x800	125	1

CHARACTERISTICS: fixed on the back of the boards.

APPLICATIONS: for applications of the 46QP boards on poles from 60 to 80mm and, by means of a banding (not included with the accessories supplied), from 80 to 200mm.

ACCESSORIES SUPPLIED: 2 pieces. For the correct use of the kit, see the instructions sheet.

GW46591



PAIR OF HANDLES FOR TRANSPORTATION

Code	Description	Pack Carton
GW 46 591	Pair of handles	1/10

APPLICATIONS: allows the 46QP boards to be transported.

NOTES: the handle kit can be used simultaneously with the pole support kit or the set of brackets, for wall mounting.

GW46521F



SET OF 4 REVERSIBLE SQUARES FOR FIXING BACK-MOUNTING PLATES OR UPRIGHTS FOR MODULAR EQUIPMENT

Code	Description	Pack Carton
GW 46 521 F	Reversible squares	1/20

APPLICATIONS: allows the combined installation of the back-mounting plate and the frame.

ACCESSORIES SUPPLIED: fixing screws and bolts.

GW46522



TRIANGULAR LOCK KIT

Code	Description	Pack Carton
GW 46 522	Triangular key	10
GW 46 523	Triangular lock	10

APPLICATIONS: for boards 46QP, QX, QM e CEP.

GW46445



SECURITY LOCK WITH HANDLE

Code	Description	Pack Carton
GW 46 445	Security lock key and handle	10

ACCESSORIES SUPPLIED: 2 keys.

NOTES: All the keys and relative locks with the same product code are identical.



68 ACS Range

ACS distribution board system for construction sites

40 CDK - UNWIRED ENCLOSURES FOR INGOING AND MEASUREMENT ASSEMBLIES

GW40103



ENCLOSURES PREARRANGED FOR HOUSING TERMINAL BLOCKS TRANSPARENT SMOKED DOOR - SMOOTH WALLS - IP65

Code	No. of modules EN 50022	Outer dim. LxHxD (mm)	Installable terminal blocks	Dispersible power (W)	Pack Carton
GW 40 103	12	298x260x140	1xGW40402	26	6
GW 40 106	18	410x285x140	1xGW40404	38	3
GW 40 104	24	298x420x140	1xGW40402	32	3

ACCESSORIES SUPPLIED: screwcaps for double insulation, module-covering masks, circuit labels.

NOTES: It is necessary use GWEnergy software to realize certification in accordance with ACS standard and the GEWISS construction standard.

68 Q-BOX - UNWIRED FINAL DISTRIBUTION BOARD

GW68465



Q-BOX 4 UNWIRED DISTRIBUTION BOARD - IP55

Code	Supplied Earth Terminal block	No. of modules EN 50022	Pack Carton
GW 68 465	(7x10 mm ²)	12	1

ACCESSORIES SUPPLIED: modular enclosure 12+1M and blank enclosure for terminal block. Set of brackets for surface-mounting.

NOTES: It is necessary use GWEnergy software to realize certification in accordance with ACS standard and the GEWISS construction standard.

GW68466



Q-BOX 6 UNWIRED DISTRIBUTION BOARDS - IP55

Code	Supplied Earth Terminal block	No. of modules EN 50022	Pack Carton
GW 68 466	(2x25mm ²)+(10x10mm ²)	24 (12+12)	1

ACCESSORIES SUPPLIED: 2 modular enclosures 12+1M each, and blank enclosure for terminal block. Set of brackets for surface-mounting.

NOTES: It is necessary use GWEnergy software to realize certification in accordance with ACS standard and the GEWISS construction standard.

COMPLEMENTARY ITEMS FOR 68 Q-BOX



SET OF 4 STEEL BRACKETS FOR FIXING SURFACE-MOUNTING BOARDS

Code	Material	Pack Carton
GW 46 446	Galvanised steel	20
GW 46 451	Stainless steel	20



POLE SUPPORT KIT

Code	For distribution boards	Pack Carton
GW 46 554	GW68531, Q-BOX 4	1

APPLICATIONS: for applying boards 68 Q-BOX 4 on poles from 60mm to 80mm.

CHARACTERISTICS: fixed on the back of the boards.

ACCESSORIES SUPPLIED: 2 pieces. For the correct use of the kit, see the instructions sheet.



PANELS FOR Q-BOX 4/6 - IP55

Code	Description	Dimensions (mm)	Pack Carton
GW 68 551	Panel - blank	270x368	1
GW 68 552	12 modules board	270x368	1
GW 68 554	4 COMBIBLOC 16-32A IP44/55	270x368	1
GW 68 556	2 IB Vert. 16-32A IP67 + 2 IEC 309 16A IP44/67 or GW27401	270x368	1
GW 68 559	5 IB Vert. 16-32A IP67 + 4 IEC 309 16A IP44/67 or GW27401	540x368	1

ACCESSORIES SUPPLIED: panels with base, fixing screws and closure.

CHARACTERISTICS:

Internal space of Q-BOX 4: 540x415mm

Internal space of Q-BOX 6: 810x415mm.



FIXING KIT FOR 160A ONE-WAY SWITCHES FOR GW68552 PANEL

Code	Description	Pack Carton
GW 68 591	For inserting from 160A	1/20



EMERGENCY PUSH BUTTON KIT

Code	Description	Pack Carton
GW 68 504	Kit containing push-button, indicator lamp cont., fuse-old	1/4



GW 68 503

12-MODULE WATERTIGHT ENCLOSURE FRONT FOR Q-BOX - IP55

Code	No. of modules EN 50022	Pack Carton
GW 68 503	12+1	1/8



GW 68 505

WATERTIGHT PLUG - SOCKET-OUTLET BLOCK

Code	Description	Pack Carton
GW 68 505	Plug/socket-outlet block	1/10

NOTE: the block is suitable for 32A (only 3P+T and 3P+N+T) and 63 A socket-outlet - plug connections.



GW 68 463

YELLOW METAL SUPPORT FOR Q-BOX 4/6

Code	Outer dim. LxHxD (mm)	Pack Carton
GW 68 463	1100x1650x630	1

CHARACTERISTICS: 2 side handles for manual handling; 2 slots on the top for lifting with a crane.



GW 46 445

SECURITY LOCK WITH HANDLE

Code	Description	Pack Carton
GW 46 445	Security lock key and handle	10

ACCESSORIES SUPPLIED: 2 keys.

NOTES: all the keys and relative locks with the same product code are identical.



GW 46 447

DOCUMENT HOLDER POCKET IN SELF-ADHESIVE INSULATING MATERIAL WITH KIT OF BLANK LABELS

Code	Dimensions (mm)	Pack Carton
GW 46 447	310x230	1/10

CHARACTERISTICS: the document wallet can be inserted in all Gewiss distribution boards starting with the 405x500x200 mm dimension.



68 ACS Range

ACS distribution board system for construction sites

MULTIFUNCTION FLOODLIGHTS

GENIUS - MOBILE USES



FLOODLIGHTS ON TUBULAR SUPPORT - IP55 - CLASS I



Code	Max lamp power	Lamp	Lamp holder	Lamp current	Colour	Weight (kg)	Pack Carton
GW 84 204	500 W	HD	R7s	2.1 A	Graphite grey	2.8	1
GW 84 205	1000 W	HD	R7s	4.3 A	Graphite grey	4.8	1

CHARACTERISTICS: protective wire guard and cable type H07RN-F section 3x1.5mm², length 5m with plug IEC 309 16A 2P+E 200-230V - IP67.
GW84204: also suitable for 200W - 300W - 400W lamps; GW84205: also suitable for 750W lamps.

GW84220

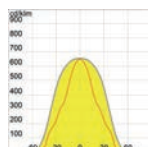

FLOODLIGHTS ON ADJUSTABLE TELESCOPIC SUPPORT (MIN 1M - MAX 2M) - IP55 - CLASS I



Code	Max lamp power	Lamp	Lamp holder	Lamp current	Colour	Weight (kg)	Pack Carton
GW 84 220	500 W	HD	R7s	2.1 A	Graphite grey	4.6	1

CHARACTERISTICS: protective wire guard and cable type H07RN-F section 3x1.5mm², length 5m with plug IEC 309 16A 2P+E 200-230V - IP67
also suitable for 150W - 200W - 300W lamps.

SPARE PARTS

Code	Description	Suitable for	Dimensions (mm)	Weight (kg)	Pack Carton
GW 88 202	Tempered glass	500 W	150x180	0.3	1/5
GW 88 223	Tempered glass	1000W	350x220	0.9	1/5

GW88202



LUMINOUS INDICATOR DEVICES

RETTA - RECTANGULAR LUMINAIRES

GW80401



VERSIONS FOR INCANDESCENT LAMPS - IP44 - CLASS II



Code	Max lamp power	Lamp	Lamp holder	Diffuser colour	Weight (kg)	Pack Carton
GW 80 401	75 W	IA/IB	E27	Transparent	0.3	12
GW 80 402	75 W	IA/IB	E27	Yellow	0.3	12
GW 80 403	75 W	IA/IB	E27	Red	0.3	12
GW 80 404	75 W	IA/IB	E27	Green	0.3	12

GW80421F



FLUORESCENT VERSIONS - IP44 - CLASS II - ELECTRONIC POWER SUPPLY

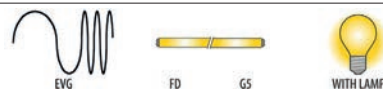

Code	Lamp power	Lamp supplied	Lamp holder	Diffuser colour	Weight (kg)	Pack Carton
Voltage: 230 / 240 V - 50 / 60 Hz						
GW 80 421 F	4 W	FD	G5	Transparent	0.4	1/12
GW 80 422 F	4 W	FD	G5	Yellow	0.4	1/12
GW 80 423 F	4 W	FD	G5	Red	0.4	1/12
GW 80 424 F	4 W	FD	G5	Green	0.4	1/12

TARTA - OVAL LUMINAIRES

GW80411



VERSIONS FOR INCANDESCENT LAMPS - IP44 - CLASS II



Code	Max lamp power	Lamp	Lamp holder	Diffuser colour	Weight (kg)	Pack Carton
GW 80 409	60 W	IA/IB	E27	Transparent	0.2	36
GW 80 410	60 W	IA/IB	E27	Yellow	0.2	36
GW 80 411	60 W	IA/IB	E27	Red	0.2	36
GW 80 412	60 W	IA/IB	E27	Green	0.2	36

CHARACTERISTICS: suitable for installation directly on to walls via screws or on to pipes using cable ties.

GW80428F



FLUORESCENT VERSIONS - IP44 - CLASS II - ELECTRONIC POWER SUPPLY

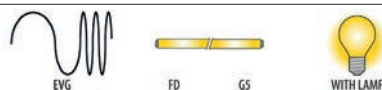

Code	Lamp power	Lamp supplied	Lamp holder	Diffuser colour	Weight (kg)	Pack Carton
Voltage: 230 / 240 V - 50 / 60 Hz						
GW 80 426 F	4 W	FD	G5	Transparent	0.3	1/12
GW 80 427 F	4 W	FD	G5	Yellow	0.3	1/12
GW 80 428 F	4 W	FD	G5	Red	0.3	1/12
GW 80 429 F	4 W	FD	G5	Green	0.3	1/12

CHARACTERISTICS: suitable for installation directly on to walls via screws or on to pipes using cable ties.

HOBBY - SHOCKPROOF PORTABLE LAMPS



VERSIONS FOR INCANDESCENT LAMPS - CLASS II

IP40 (VERSION WITH COVER) - IP20 (VERSION WITH CAGE)



Code	Max lamp power	Lamp	Lamp holder	Type	Cable length	Weight (kg)	Pack Carton
GW 80 417	40 W	IA/IB	E27	With diffusor	6 m	0.6	16
GW 80 418	40 W	IA/IB	E27	With cage	4 m	0.5	16

ACCESSORIES SUPPLIED: cable section 2x0.75mm² type H05VV-F with plug 2P 10 A - 250V Italian standard.

CHARACTERISTICS: GW80417, with single-pole one-way switch 3 A 250 V.

